

How to Service a Direct Flow™ System

Servicing the Direct Flow™ Air Cleaners

1. Open the metal latches to remove the service cover.

DF600 Element Size

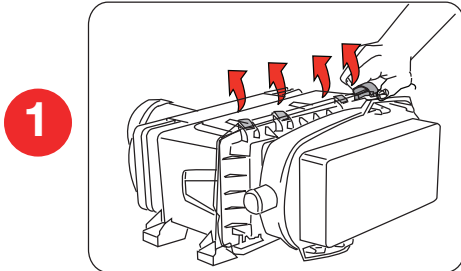

DF900 Element Size

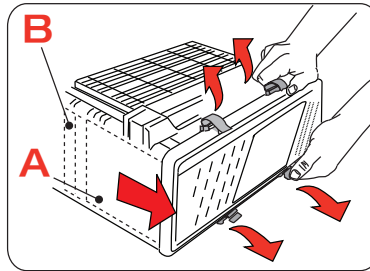

DF1200 Element Size

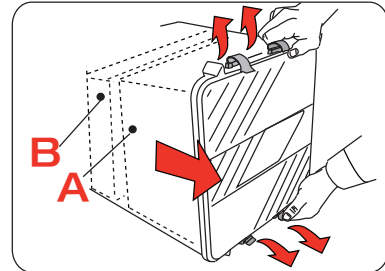

2. Remove the primary element. .

DF600 Element Size

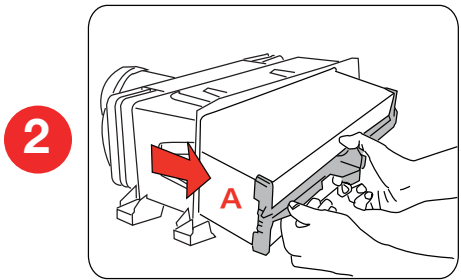

DF900 Element Size

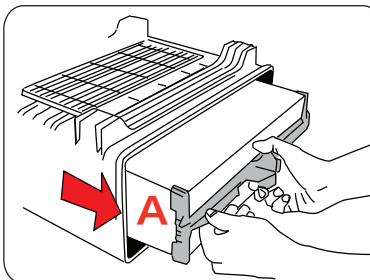

DF1200 Element Size

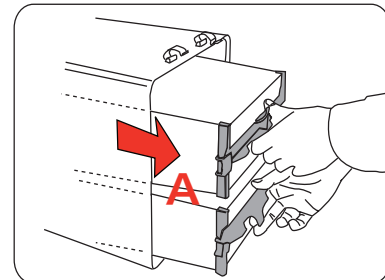

3. Remove the secondary element. .

DF600 Element Size

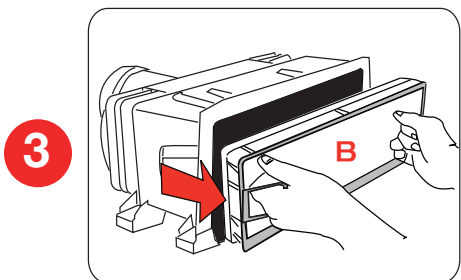

DF900 Element Size

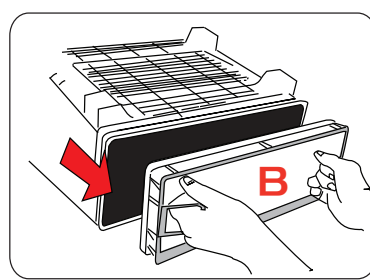

DF1200 Element Size

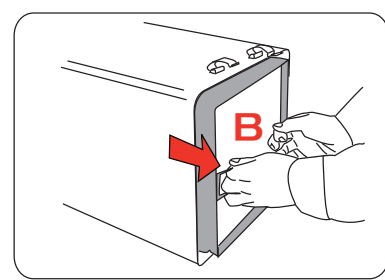

4. Replace the primary and secondary elements in the same order and close the metal latches. .

DF600 Element Size

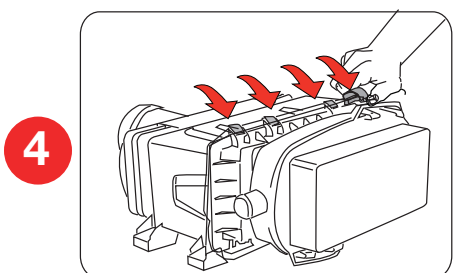

DF900 Element Size

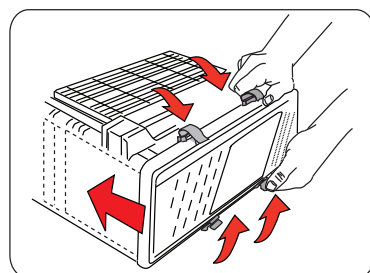

DF1200 Element Size

